

BENDIGO HEALTH MENTAL SERVICES

Bendigo Health is an accredited health organisation, consisting of acute care services, rehabilitation centre, residential care, mental health services, palliative, hospice care and a broad range of extended and community services.

Bendigo Health Mental Health Services provides Child and Adolescent, Youth, Adult and Older Persons Community and Inpatient mental health services (including a Parent Infant Unit & Dual Diagnosis Unit) to people in the Loddon Campaspe Southern Mallee region of Victoria.

Bendigo Health Mental Health Services actively supports and encourages educational opportunities for staff, offering a comprehensive range of programs to facilitate continuing professional development. With Mental Health services increasing there exists enhanced career opportunities for Mental Health Nurses.

Mental Health Graduate Nurse Program Aims

If you interested in working in an exciting, innovative area of nursing, offering you unlimited opportunities for work variety and rapid advancement, then the Mental Health Graduate Nurse Program (GNP) is for you. The principal aim of our specialist Mental Health GNP is to support new graduates during their first year of nursing to develop the skills, knowledge, applied experience and values to become an effective member of the mental health nurse workforce.

MENTAL HEALTH GRADUATE NURSE PROGRAM (GNP) OUTLINE

- Program commences January 30, 2023.
- GNP is conducted over 52 weeks, 4 days a week (0.8 EFT), rotating through day and evening shift, no night shift is expected during the year.
- First week consists of 5 concurrent orientation days designed to enable work readiness .
- 12 paid study days held monthly over the year.
- 3 clinical rotations of 4 months each in either Child & Adolescent, Youth, Adult or Older Person Inpatient, Residential or Community settings. Graduate preferences for rotations are invited.
- Community rotations are supernumerary and inpatient rotations have at least 3 supernumerary days at placement commencement.
- Monthly individual and group clinical supervision is mandatory for all graduates.
- Preceptor allocated for each rotation.
- Comprehensive, ongoing competency based skills assessments.
- Successful completion of the Graduate Program meets the requirements for making application of 30 credit points of advanced standing in the Post Graduate Diploma of Mental Health Nursing exit point of the Master of Mental Health Nursing
- Once the GNP year is complete and the graduate has gained employment the opportunity to complete the Master of Mental Health Nursing will be available.

PROGRAM COMPLETION

To successfully complete the Bendigo Health Mental Health Graduate Nurse Program, participants are required to complete 12 months employment at Bendigo Health, attend and participate in the 12 study days, demonstrate an appropriate level of competence in mental health nursing practice for a beginning practitioner and successfully complete the theoretical components to the level of the Postgraduate Certificate of Mental Health Nursing at LaTrobe University

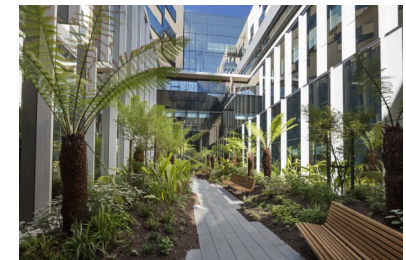

Excellent Care. Every Person. Every time.



MASTER OF MENTAL HEALTH NURSING

Our Graduate Program attracts credit towards the Master of Mental Health Nursing at La Trobe University.

Please see the web page for further details:
<https://www.latrobe.edu.au/courses/master-of-mental-health-nursing>

Successful graduates will be asked to make application to the Master of Mental Health Nursing at La Trobe University. When doing this please upload your offer of graduate year, Bachelor of Nursing transcript and your current registration as a Registered Nurse to indicate you meet the entry criteria.

All Graduates will reach the level of Graduate Diploma of Mental Health Nursing by the end of their Graduate year

Course information

Professor Phil Maude
Postgraduate Mental Health Coordinator
La Trobe Rural Health School
Email: p.maunder@latrobe.edu.au

Admissions enquiries - 1300 135 045

MENTAL HEALTH PROFESSIONAL DEVELOPMENT UNIT (MHPDU)

- Promotes the speciality of mental health nursing practice
- Enhances mental health practice through reflective and evidence based approaches to education and professional development
- Contributes to undergraduate and postgraduate mental health education
- Promotes and facilitates the ongoing professional development of mental health clinicians
- Promotes and facilitates mental health research
- MHPDU manages the Mental Health Services Graduate Program

For any questions about preparation for interviews and applications for a Graduate Position in the

Bendigo Health Mental Health Services GNP please contact:

Cindy or Sam on 5454 7612 or email mhpdutraining@bendigohealth.org.au to book an appointment to speak with one of our friendly educators.



MENTAL HEALTH GRADUATE NURSE PROGRAM

Information for Prospective Mental Health Graduate Nurses

